

HOW TO
DECORATE YOUR NEW
ALUMINUM CHRISTMAS TREE



Proper decoration will make your aluminum tree more beautiful

Many thousands of American families now place Christmas gifts beneath a new type of Christmas tree—a tree made mostly of nontarnishing, long-lasting aluminum foil!

Foil trees are strikingly beautiful, with or without decorations. And with this beauty there is no fire hazard or dropping of needles.

The National Safety Council says any type of Christmas tree can be dangerous. The possibility of frayed light cords is a potential hazard whether the tree is a live green one, or made of metal.

This booklet, prepared by Aluminum Company of America, and reviewed by The National Safety Council for safety

aspects, presents some ideas for decorating aluminum trees.

The decoration ideas come from the company's design consultant, Conny of Alcoa.

☆ ☆ ☆

Decorated with plain ornaments and inexpensive spotlights, aluminum trees develop a spectacular ethereal beauty. Each needle is a mirror-like strip of aluminum foil. The strips catch even the tiniest gleam of color or light, and reflect it with ice-clear brilliance.

The trees develop special beauty when illuminated by a colored spotlight—even without ornaments. Pink, green, blue, red, amber—any color or shade will do.

One spot is sufficient, although two will serve to heighten the outstanding effect.

Place the spotlight (or spotlights) in front or at the sides of the tree.

For more spectacular effects, a spotlight with a rotating color wheel can be purchased.* The rotating wheel slowly changes the sparkling color of the tree.

A rotating tree base is another "plus" that will heighten the brilliant appearance of an aluminum tree. As the tree rotates, it comes to life—looking like a beautiful metallic prism.

Remember: Use Underwriters' Laboratories approved electrical equipment!

Tip: When using a standard tree base, cover it with sparkling Alcoa Wrap household foil to match the tree.

☆ ☆ ☆

A spotlight, as the only decorating technique, produces a dazzling aluminum tree, especially at night. To add daytime color and brilliance, ornaments can be added. The mirror-like needles of the trees pick up the color of ornaments and reflect their color throughout the area surrounding each ornament.



Lovely effects can be achieved with ornaments of one color only, such as red, blue, pink or green. Ornaments can be the same size or, if you prefer, two sizes can be varied with excellent effect.

If ornaments of more than one color are used, they should be divided evenly as to the number of each color. Some unusually beautiful effects can be achieved with ornaments made at home. A series of designs and instructions, created by Conny of Alcoa, are presented later in this booklet.

Tip: Be certain to hang ornaments with wide hooks that will not distort the tree's foil needles.

With the use of spotlights, special tree bases and ornaments, aluminum trees reach the ultimate in beauty and safety. You may want to add your own touches, but stay close to the recommendations above to take full advantage of the inherent characteristics of the tree.

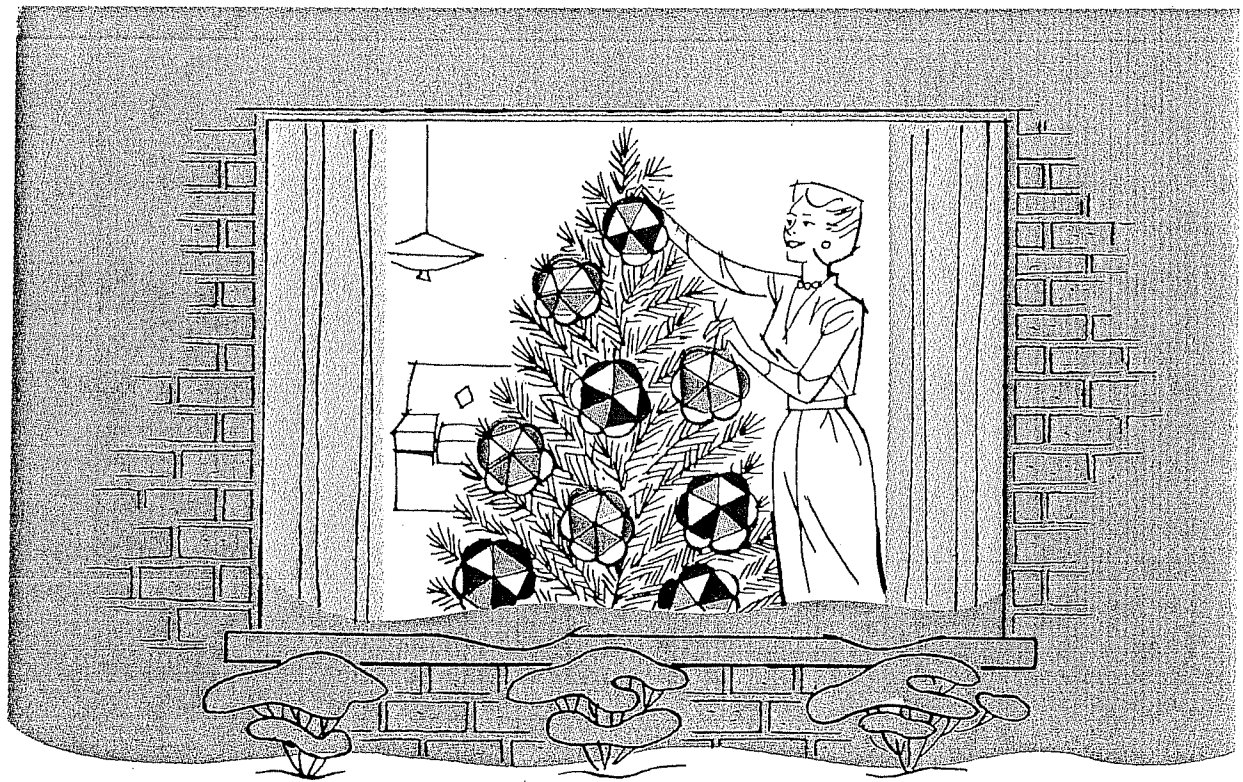

Some Do's and Don'ts

Before putting up your aluminum Christmas trees, check over this list of do's and don'ts to get maximum satisfaction from your purchase:

- Do...** assemble the tree trunk first and place it in the stand.
- Do...** when placing limbs into the trunk of your tree, start from the top down and place limbs carefully in holes in the trunk. Hold the limbs at the base, not in the center where you will bend the needles.
- Do...** use spotlights to light your tree. Special effects include rotating color wheels or rotating tree holders.
- Do...** decorate with glass or aluminum ornaments, preferably all the same color.
- Do...** use wide-mouth ornament hooks.
- Do...** when taking down your tree, remove ornaments carefully. Remove limbs from the top down, again holding them by the base near the trunk to protect the needles. Stored carefully in the original carton, your Alcoa aluminum tree will provide Christmas beauty in your home for years to come!
- Do...** remember to use *only* Underwriters' Laboratories approved electrical equipment!
- Don't...** tie on ornaments with string or wire that will distort needles. Use the wide-mouth hooks sold in all stores.
- Don't...** put tinsel, chains or streamers around aluminum trees. They clutter the inherent beauty.
- Don't...** display trees outdoors. Rain or snow can dull or stain the brilliant needles and destroy their beauty. If you want them seen outside, place them in a window or on a protected porch.

Added fun for the whole family in the weeks before Christmas is to initiate a project of making decorations of brightly colored aluminum foil gift wrap.

Conny of Alcoa has designed a few that are particularly impressive when hung on foil Christmas trees.

Foil Butterflies

One beautiful series of ornaments you can make are red and silver butterflies. Conny has used Alcoa Wrap aluminum foil and red Twinkle Foil, a new gift wrap featuring tiny multicolored foil stars on a red foil background. Plain red gift wrap could also be used.

Here's how the butterflies are made:

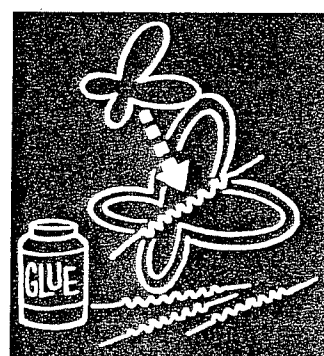

Glue sheets of foil gift wrap together, paper to paper. When dry, cut about 50 butterfly shapes of one size and 50 more a little smaller. Next, cut the same number of butterfly shapes from Alcoa Wrap household foil, making these a little larger than the smallest of the red ones. Now, assemble the shapes by gluing the

smaller to the larger, with the plain foil shape between the two red ones. Insert a pipe cleaner or thin wire between the two bottom layers before applying glue. Thus, the butterflies can be attached to the tree limbs.

Shown in the illustration with this tree is a rotating color spotlight.



Birds

Another design by Conny, perfect for a Christmas table decoration, is this small two-foot tree with blue foil birds.

To make the birds, glue sheets of blue foil gift wrap together, paper to paper. Now, cut bird shapes from the foil and cut out a wing by cutting two curved slits in the side of each bird. Bend the wing-shape out and insert the foil needles of the aluminum tree through openings.

Blue Globes

For really spectacular ornaments, try the bright, shiny blue globes shown decorating this five-foot tree.

The globes are made of blue foil gift wrap. They take a little time, but the result is worth it!

Here's how:

Cut 18 circles of foil gift wrap—all the

same size—for each globe. Vary the size of globe by cutting circles large or small.

Cut a triangle of cardboard. Place triangle on top of each foil circle, score foil exposed beyond triangle edges by turning up, creasing along sides of triangle.

When 18 of these circles are scored in this manner, begin the globe by pasting

two circles together at the scored edge. Now, build the globe by gluing folded edges of circles together to form a globe.

Punch a small hole in one of the upright portions of the globe and slip in a wide-mouthed ornament hanging hook.

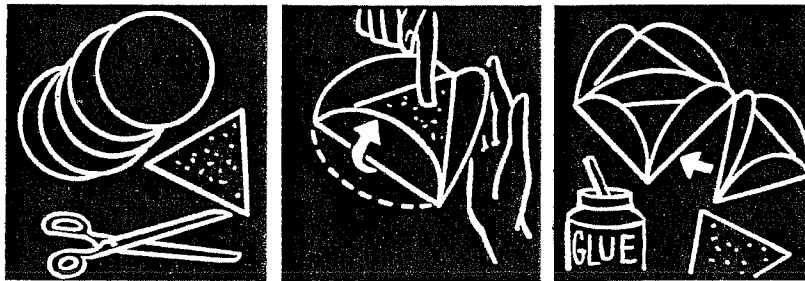
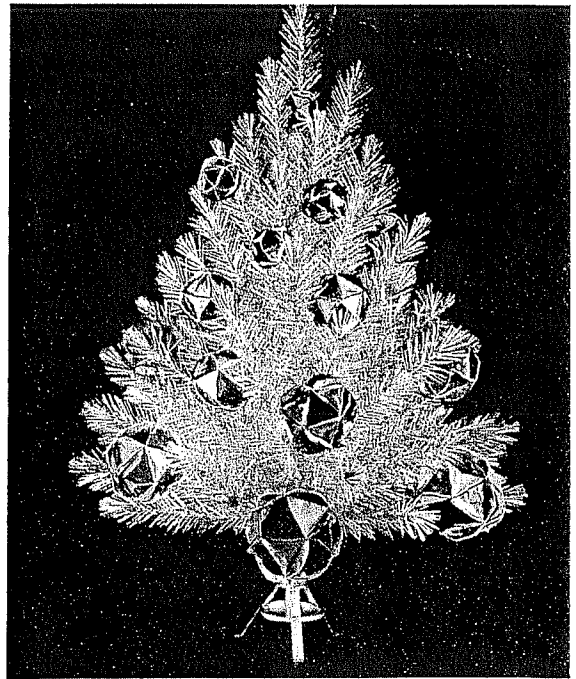

Cone Clusters

Another beautiful decoration design is used for the tree shown here. It is decorated with pink ornaments and green and silver cone clusters.

Make the clusters by gluing Alcoa Wrap aluminum foil on the paper side of green foil gift wrap. When dry, cut out three-inch circles with pinking shears.

Now, cut into the center of each circle and form into a cone, securing with cellophane tape. Gather four or five cones together and pass a thread through the points with the aid of a needle. Tie securely. This makes one decoration. Repeat the process for as many additional decorations as are needed. Slip an ornament hook through the threads at points of cluster for hanging on the tree.

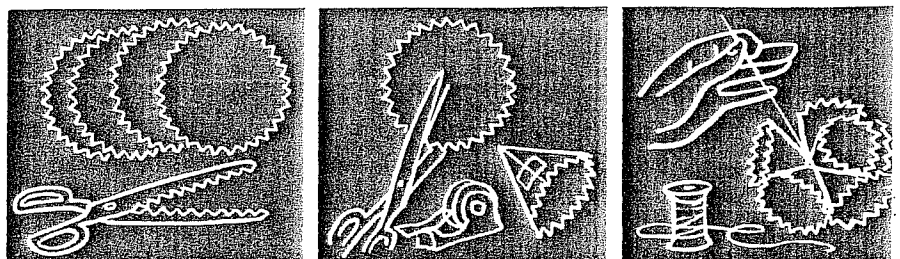

Aluminum foil gift wraps offer an endless variety of colors and textures. Use them with contrasting colors of ribbon for truly outstanding gift packages.

Here are some suggestions from Conny of Alcoa for distinctive gifts:

Unusually shaped gifts can be wrapped with foil gift wrap to resemble whimsical figures, according to Conny.

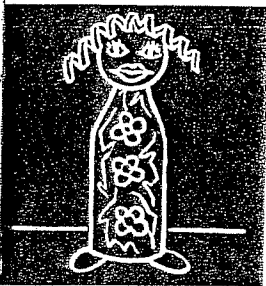

Bottles

If the gift is liquid in a tall bottle, cover completely with red foil gift wrap. Glue a foam ball to the top and decorate with face features cut from black construction

paper or felt. Glue large black circles of the same material down the front of the bottle for buttons, and add two ovals at the bottom of the bottle for feet.

Pin or glue small loops of red ribbon to the top of the foam head for hair.

Umbrellas

A gift umbrella for a lady or a man can be wrapped in pink or blue foil gift wrap. Tie a bright ribbon bow around the base of the handle and cover and pad the handle with Alcoa Wrap aluminum foil. Smooth the foil "head"

and glue black yarn strands to the top for hair. Add eyes, nose and mouth of paper or felt for the face.

Gift Boxes

When wrapping gifts in a box, Conny suggests covering lid and box separately

with foil gift wrap so that the box can be re-used.

Fold foil carefully at box corners to prevent tearing.

For decorations, make butterflies described on page 5 and glue two or three to top of box.

This same idea can be used with star, angel, or Christmas tree shapes.

Hat Box Containers

An empty coffee can makes a perfect container for homemade candies or cookies for gift-giving. For a bit of whimsy, decorate the can to resemble a tiny hat box. Here's how:

Trace around the lid of the coffee can with pencil on the paper side of foil gift wrap. Do this twice and cut out circles. Glue to top and bottom of can. Now, wrap sides of can with another piece of gift wrap cut to the height of the can, and glue in place.

When can is completely covered, glue on travel stickers made with crayon on small pieces of white or colored construction paper.

Make a handle of double thickness of construction paper or double-faced plastic tape, and glue each end of handle to side of can.

