

Tool & Product Update

Model 225 H.I.T. Throttle Arm Cover Revision serial number 0686 and below

Removing throttle cover P/N 112671 and replacing with throttle cover P/N 114209 and screws 501267 (2).

1. See Figure 1. Unscrew both button head screws (1) with 1/16 hex key and remove throttle cover from handle.
2. See Figure 2. Position throttle cover (4) around handle (3). Carefully center closed end of cover over throttle valve—clearance must be allowed for throttle valve operation. Push pencil into hole A and, with throttle cover carefully centered, mark center of hole on cylinder (6).

Caution

Do not drill hole beyond .280 deep. If hole is drilled too deep, drill will enter cylinder and air may leak past screw. Loss of operating pressure will result. If hole goes thru cylinder wall, apply LOCTITE adhesive/sealant to threads to stop air leaking.

3. Remove throttle cover. Center punch pencil mark deep enough to start a #29 (.159) pointed drill. Hold drill vertical to surface and drill into cylinder just enough to start a hole. Use a #21 flat bottomed drill to complete the hole to a maximum depth of .280, while holding the drill vertically. Use #10(.190)-32 UNF-2B to tap the hole to a minimum depth of .220.

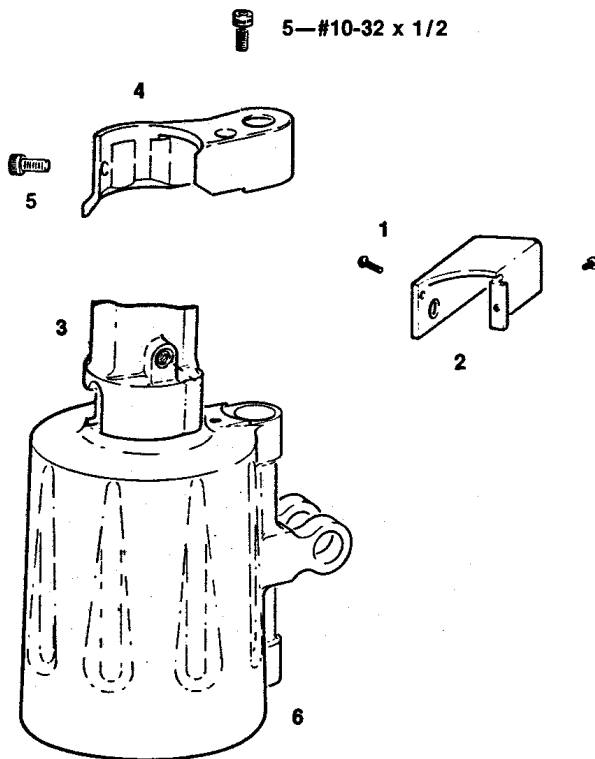

Figure 1.

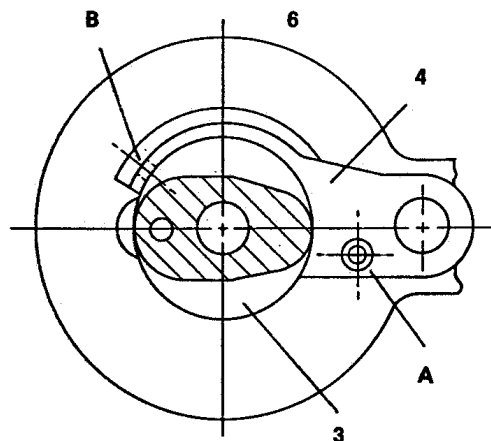

Figure 2.

11-20-82

204

(sht. 1 of 2)

225 H.I.T. Throttle Arm Cover Revision (cont.)

Caution

Do not drill hole beyond .450 deep. If hole is drilled too deep, tool will be damaged.

4. Place throttle cover on handle. Screw in socket head cap screw (5), and tighten with 3/32 hex key. Push pencil into hole B and mark center of hole on handle. Remove throttle cover from handle. Center punch pencil mark. Hold drill at right angle to surface and drill hole with #21 (.159) drill—.450 deep. Tap hole with #10-32 UNF tap to depth of .320.
5. Place throttle cover on handle and screw in both #10-32 x 1/2 screws loosely. After both screws are engaged in threads, tighten screws.

11-20-82

204

(sht. 2 of 2)